

Lift company information/Delivery data (Important: please fill in)

Client, contact person and telephone	Delivery address
<input type="text"/>	<input type="text"/>
Client code	Branch code
<input type="text"/>	<input type="text"/>
Required delivery date	
<input type="text"/>	

General characteristics

Load	Travel (R)	Power supply (±5%)
<input type="checkbox"/> 225 kg (Surf. ≤ 0,90 m ² , PL = 700) <input type="checkbox"/> 300 kg (Surf. ≤ 1,20 m ² , PL ≤ 800) <input type="checkbox"/> 400 kg (Surf. ≤ 1,54 m ² , PL ≤ 900)	<input type="text"/> mm	<input type="checkbox"/> 230V 1~ 50 Hz <input type="checkbox"/> Other <input type="text"/>
Nr Stops (2, 3 ó 4)		
<input type="text"/>		

Car characteristics

Entrance layout				
<input type="checkbox"/> 2	<input type="checkbox"/> 3	<input type="checkbox"/> 4	<input type="checkbox"/> 5	<input type="checkbox"/> 6
Finishing				
<input type="checkbox"/> Standar	<input type="checkbox"/> Advance	<input type="checkbox"/> Advance Nature	<input type="checkbox"/> Elegance	<input type="checkbox"/> Exclusive
Walls				
<input checked="" type="checkbox"/> Laminated sheet <input type="checkbox"/> Pearly grey U-59 <input type="checkbox"/> Cream white U-63 <input type="checkbox"/> Young ivory U-57	<input checked="" type="checkbox"/> Laminated sheet <input type="checkbox"/> Mist grey U-60 <input type="checkbox"/> Bordeaux U-69 <input type="checkbox"/> Capry blue U-58	<input checked="" type="checkbox"/> Laminated sheet <input type="checkbox"/> Walnut E-25 <input type="checkbox"/> Old oak E-501 <input type="checkbox"/> Beach wood E-44	<input checked="" type="checkbox"/> Laminated sheet <input type="checkbox"/> Abisal black UD60 <input type="checkbox"/> Atlantic blue U-85 <input type="checkbox"/> Graphite grey U-07 <input checked="" type="checkbox"/> St. steel mirror wall <input type="checkbox"/> Glazed wall	<input checked="" type="checkbox"/> Brushed st. steel <input checked="" type="checkbox"/> St. steel mirror wall <input type="checkbox"/> Glazed wall
Floor				
<input checked="" type="checkbox"/> Vynil flooring <input type="checkbox"/> Braz. walnut 3997 <input type="checkbox"/> Nocturne 1380 <input type="checkbox"/> Delta blue 1220	<input checked="" type="checkbox"/> Vynil flooring <input type="checkbox"/> Silver mist 1430 <input type="checkbox"/> Satin wood 1370 <input type="checkbox"/> Golden maple 3277	<input checked="" type="checkbox"/> Artificial stone <input type="checkbox"/> Capri white <input type="checkbox"/> Ivory coast	<input checked="" type="checkbox"/> Artificial stone <input type="checkbox"/> Spa concrete <input type="checkbox"/> Expo grey	<input checked="" type="checkbox"/> Artificial stone <input type="checkbox"/> Tebas black <input type="checkbox"/> Expo grey
Options				
<input type="checkbox"/> Half mirror	<input type="checkbox"/> Half mirror <input checked="" type="checkbox"/> Handrail <input checked="" type="checkbox"/> Double lighting	<input type="checkbox"/> Half mirror <input checked="" type="checkbox"/> Handrail <input checked="" type="checkbox"/> Double lighting	<input type="checkbox"/> Column shape mirror <input checked="" type="checkbox"/> Handrail <input checked="" type="checkbox"/> Double LED lighting <input checked="" type="checkbox"/> Intercom	<input type="checkbox"/> Column shape mirror <input checked="" type="checkbox"/> Handrail <input checked="" type="checkbox"/> Double LED lighting <input checked="" type="checkbox"/> Intercom

Door characteristics

Car	Landing	Entrances
<input type="checkbox"/> No doors (with light curtain) <input type="checkbox"/> No doors (with light curtain) <input type="checkbox"/> Folding with vision panel <input type="checkbox"/> Folding glazed <input type="checkbox"/> 2 leaf telescopic st. steel <input type="checkbox"/> 3 leaf telescopic st. steel	<input type="checkbox"/> Swing semiaut. vision panel <input type="checkbox"/> Swing semiaut. glazed <input type="checkbox"/> Swing semiaut. vision panel <input type="checkbox"/> Swing semiaut. glazed <input type="checkbox"/> 2 leaf telescopic. painted <input type="checkbox"/> 3 leaf telescopic. painted	<div style="display: flex; justify-content: space-around;"> <div style="text-align: center;"> <p>1</p> <p>Clear opening (mm) <input type="text"/></p> <p>Hand (swing doors) <input type="text"/></p> <p>Right hand </p> <p>Stops with this entrance <input type="text"/></p> </div> <div style="text-align: center;"> <p>2</p> <p>Clear opening (mm) <input type="text"/></p> <p>Hand (swing doors) <input type="text"/></p> <p>Left hand </p> <p>Stops with this entrance <input type="text"/></p> </div> </div>
Options		
<input type="checkbox"/> Automatic landing door operator (swing doors)		

Miscellaneous

Options	Push button panel
<input type="checkbox"/> Step ladder for maintenance from the car <input type="checkbox"/> Self-supporting structure, metal plate enclosure <input type="checkbox"/> Self-supporting structure, glazed enclosure Flexible piping length <input type="text"/> m (standard 3m) <input type="checkbox"/> Shaft lighting	Landing designation <input type="text"/> Logotype in characteristics plate <input type="text"/> Reference in characteristics plate <input type="text"/>
	Packing options
	<input type="checkbox"/> In wooden box

Dimensions

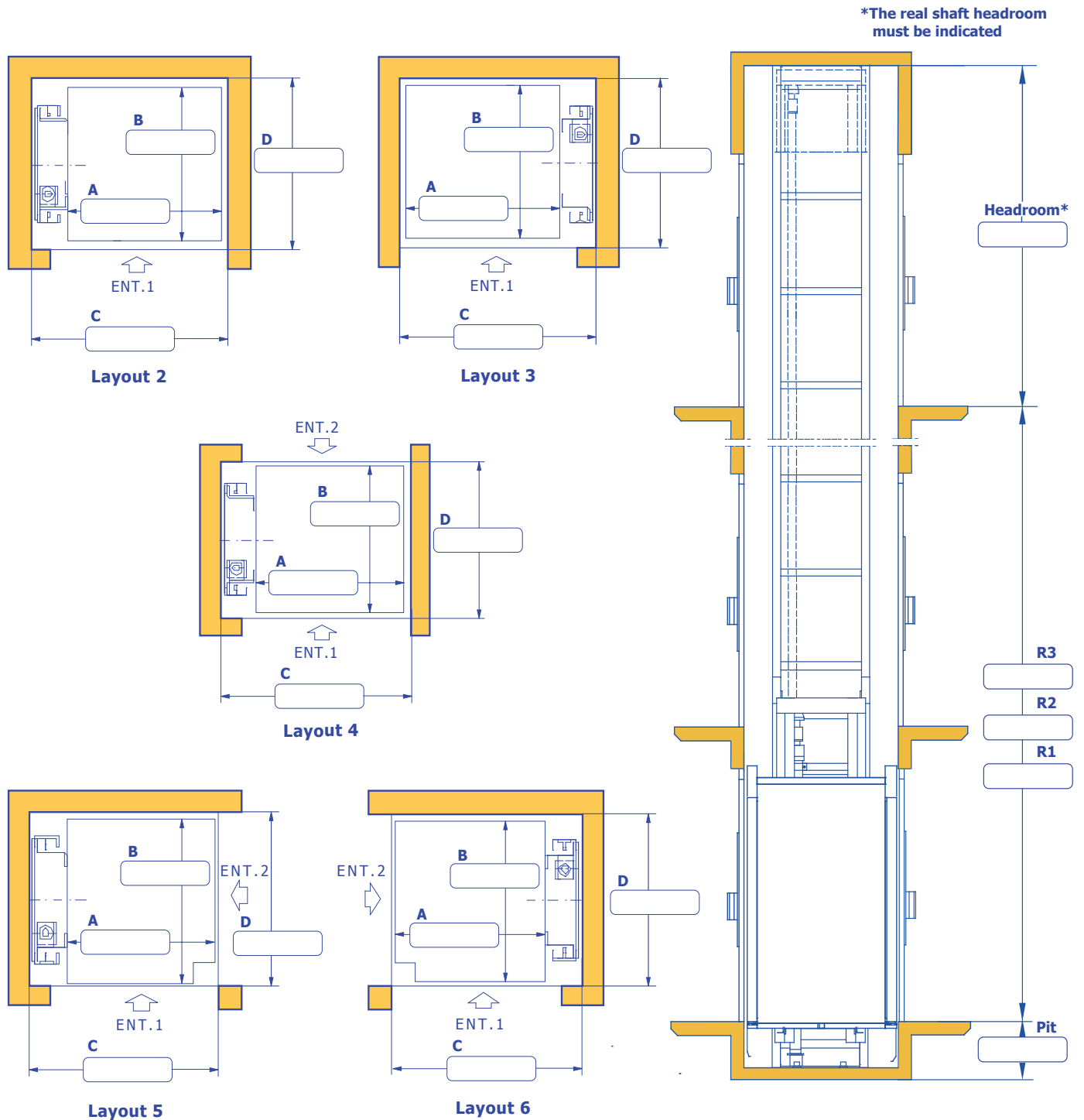

Remarks